

REVISIONS			
REV.	DESCRIPTION	DATE	APPROVED
Ø	INITIAL DRAWING RELEASE	12/07/99	MSP
A	REVISED TO GENERIC STANDARD PRODUCT	07/26/00	MSP
B	INITIAL SOLIDWORKS DRAWING RELEASE	04/23/12	JEH

NOTES: UNLESS OTHERWISE SPECIFIED

- DEBURR SHARP EDGES .015 MAX.
- CHAMFER ALL THREADS .01 PAST ROOT DIAMETER.
- REFLECTOR TO BE REPLICATED FROM SPECIFIED MASTER TOOL EXHIBITING REQUIRED GEOMETRY AND SPECULAR SURFACE FINISH OF 80-50 SCRATCH-DIG PER MIL-0-13830A.
- NOMINAL THICKNESS (T) MAY VARY ± T/4 WITHIN .25 OF EDGES.
- VERTEX HOLE OPENING IS PREFERRED REGISTRATION FEATURE FOR AXIAL ALIGNMENT OF REFLECTOR. PLANE OF CLEAR APERTURE NOT RECOMMENDED FOR THIS PURPOSE.

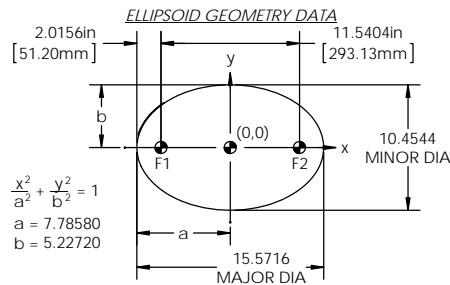
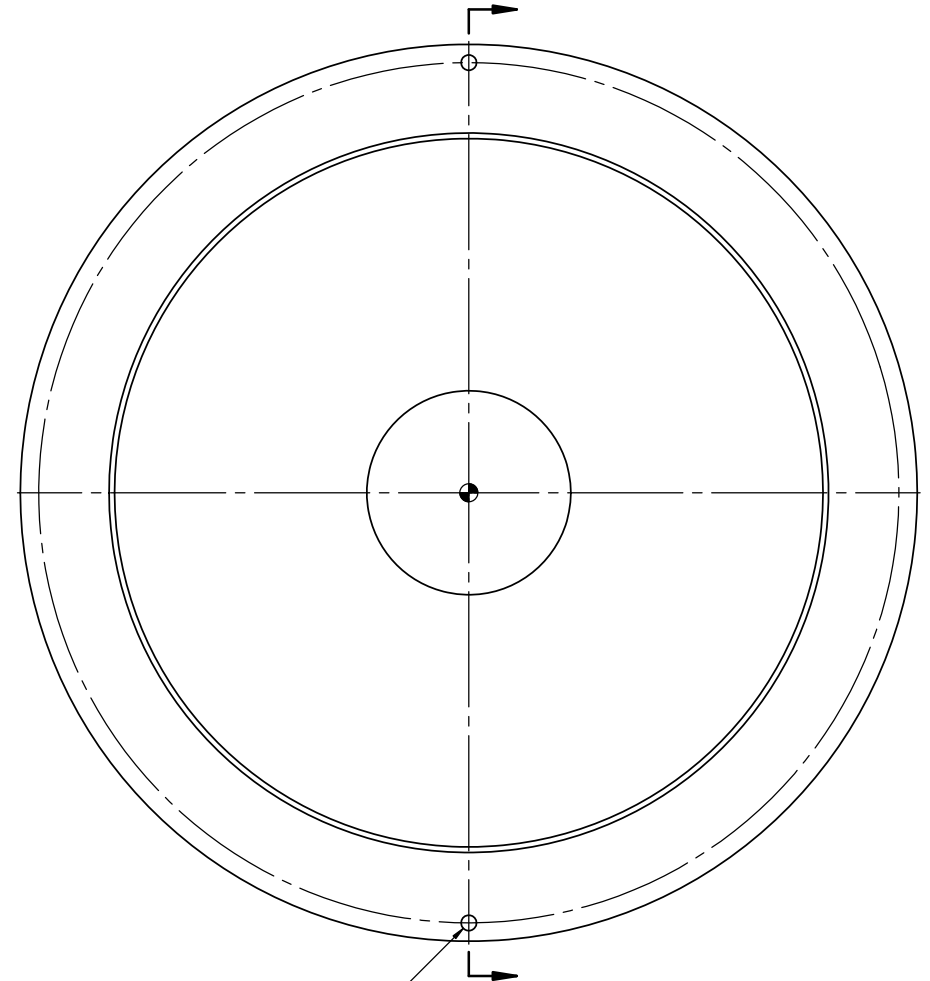
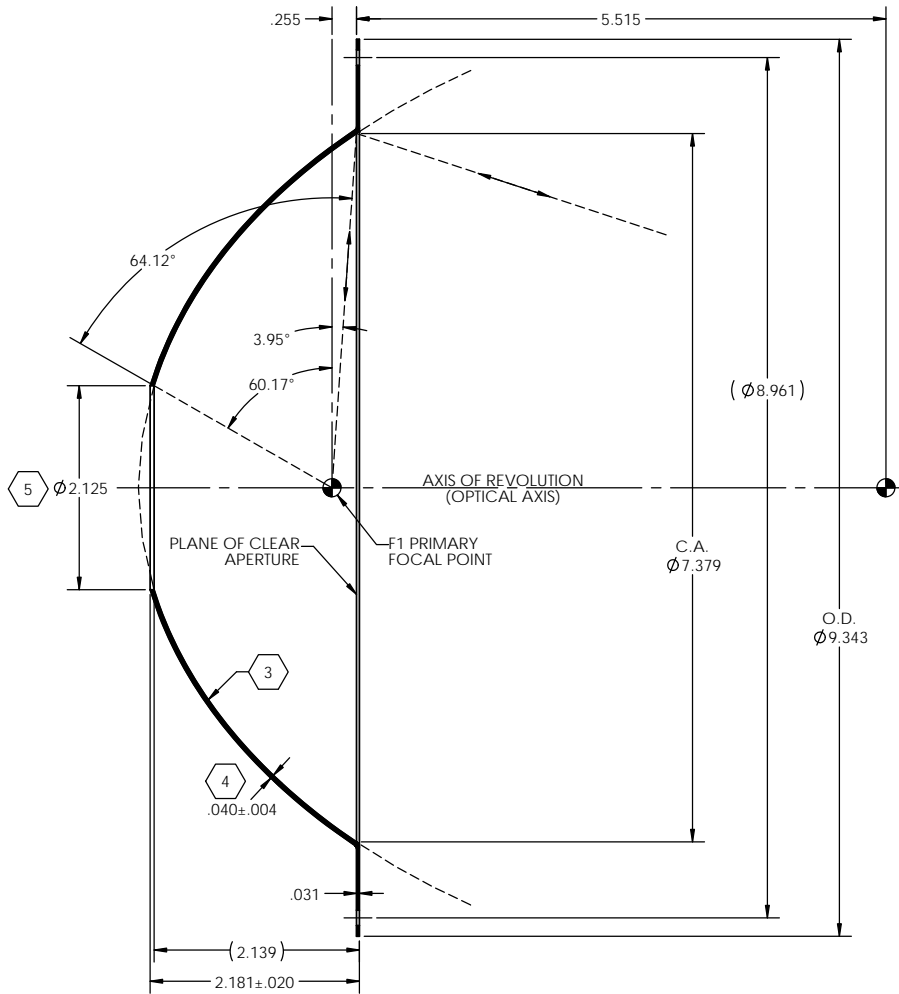

EF SURFACE AREA: 0.5540 SQ. FT.

UNLESS OTHERWISE SPECIFIED DIMENSIONS ARE IN INCHES TOLERANCES ARE:		CONTRACT NO. 00-E293		42310 WINCHESTER RD. TEMECULA, CA 92590 WWW.OPTIFORMS.COM	
FRACTIONS ± 1/16		DECIMALS .XX ± .003 .XXX ± .005		APPROVALS DATE	
MATERIAL ELECTROFORMED NICKEL - LSSN TYPE 1		DRAWN JEH 04/26/12		REFLECTOR, ELLIPTICAL	
FINISH NOTE 3		CHECKED		11.54"/293mm (F1-F2)	
NEXT ASSY		ENGR KMT 04/26/12		SIZE C	
USED ON		DESIGN ACTIVITY		CAGE CODE 0Y1Y4	
APPLICATION		-DO NOT SCALE DRAWING-		DWG. NO. E293-0100	
				SCALE 1:1	
				CAD NO. E293	
				SHEET 1 OF 1	