

REVISIONS			
REV	DESCRIPTION	DATE	APPROVED
Ø	INITIAL DRAWING RELEASE	01/09/15	RRS

NOTES: UNLESS OTHERWISE SPECIFIED

- 1 ELECTROFORM REFLECTOR FROM MASTER TOOL WITH SPECULAR SURFACE FINISH OF 80-50 SCRATCH-DIG PER MIL-O-13830A.
- 2 NOMINAL THICKNESS (T) MAY VARY ± T/4 WITHIN .25 OF EDGES.
- 3 VERTEX HOLE OPENING IS THE PREFERRED REGISTRATION FEATURE FOR AXIAL ALIGNMENT OF THE REFLECTOR. PLANE OF CLEAR APERTURE NOT RECOMMENDED FOR THIS PURPOSE.

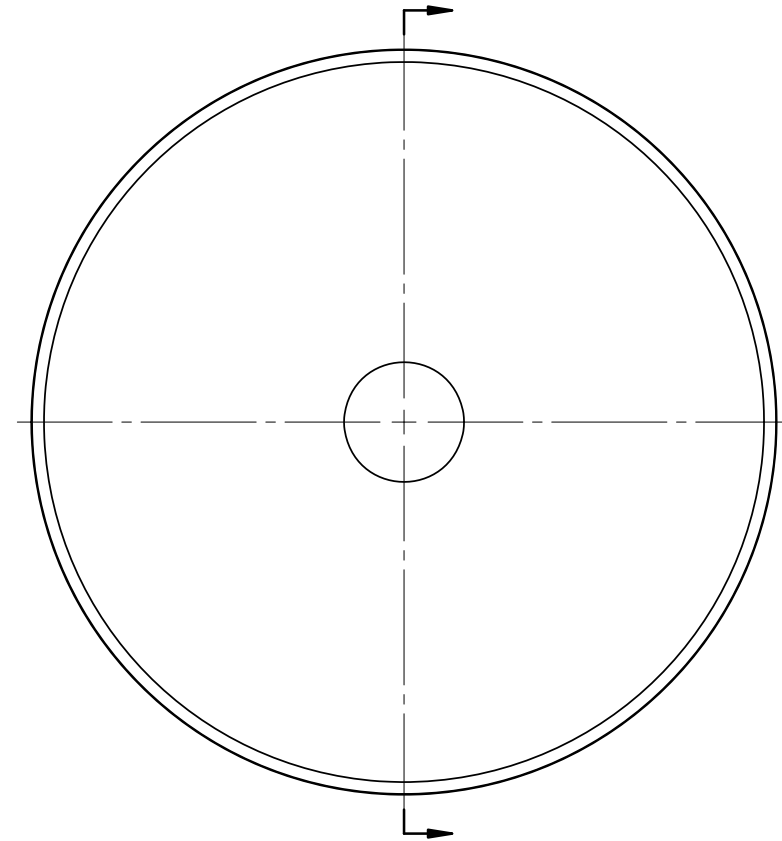
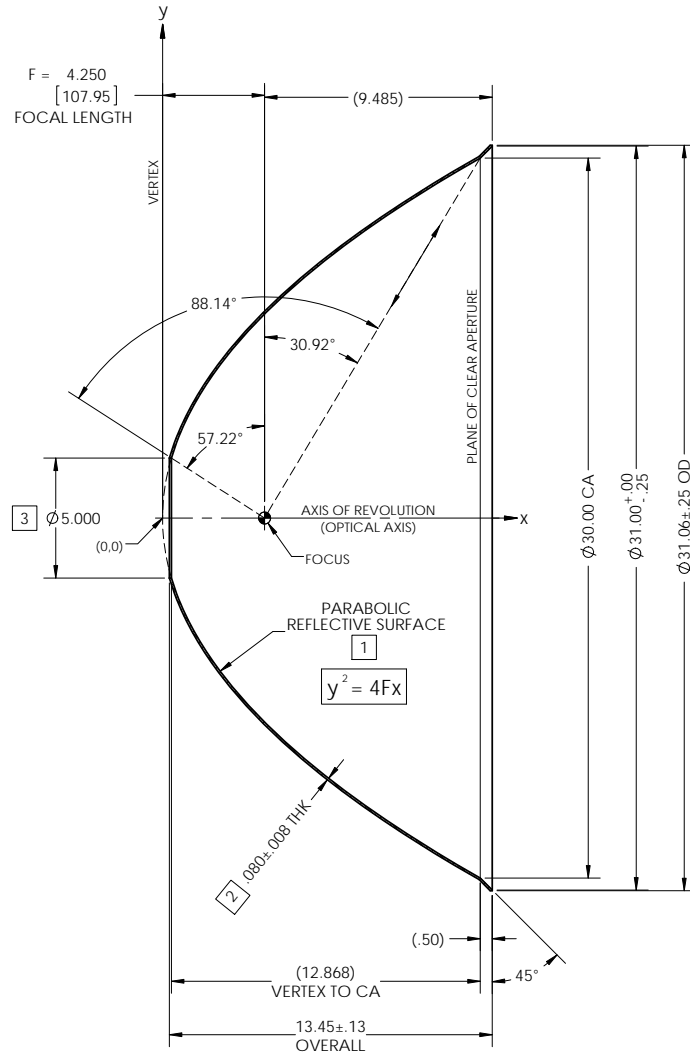

EF SURFACE AREA = 8.0496 SQ. FT.

UNLESS OTHERWISE SPECIFIED DIMENSIONS ARE IN INCHES [mm] GD&T PER ASME Y14.5-2009 DO NOT SCALE DRAWING		CONTRACT NO. 15-P108		42310 WINCHESTER RD. TEMECULA, CA 92590 WWW.OPTIFORMS.COM	
TOLERANCES		DRAWN RRS DATE 01/09/15			
FRACTIONS ± 1/16	DECIMALS ± .02	ANGLES ± 1/2°	CHECKED DATE	REFLECTOR, PARABOLIC 4.25" / 108mm FL	
SURFACE ROUGHNESS DEBURR SHARP EDGES & HOLE RIMS: 015 MAX. CHAMFER THREADS: Ø1 PAST ROOT DIAMETER			ENGR KMT DATE 01/09/15	MATERIAL ELECTROFORMED NICKEL - LSSN TYPE 1	
NEXT ASSY	USED ON	THIRD ANGLE PROJECTION	FINISH NONE	SCALE 1:4	WT. (REF) 29.674 lbs.
APPLICATION			SCALE 1:4	CAGE CODE OY1Y4	DWG. NO. P108-0100
			SCALE 1:4	CAD NO. P108	REV Ø
			SCALE 1:4	CAD NO. P108	SHEET 1 OF 1