

REVISIONS			
REV.	DESCRIPTION	DATE	APPROVED
Ø	INITIAL SOLIDWORKS DRAWING RELEASE	04/16/12	JEH

NOTES: UNLESS OTHERWISE SPECIFIED

- SPECIFICATION CONTROL DRAWING.
- DEBURR SHARP EDGES .015 MAX.

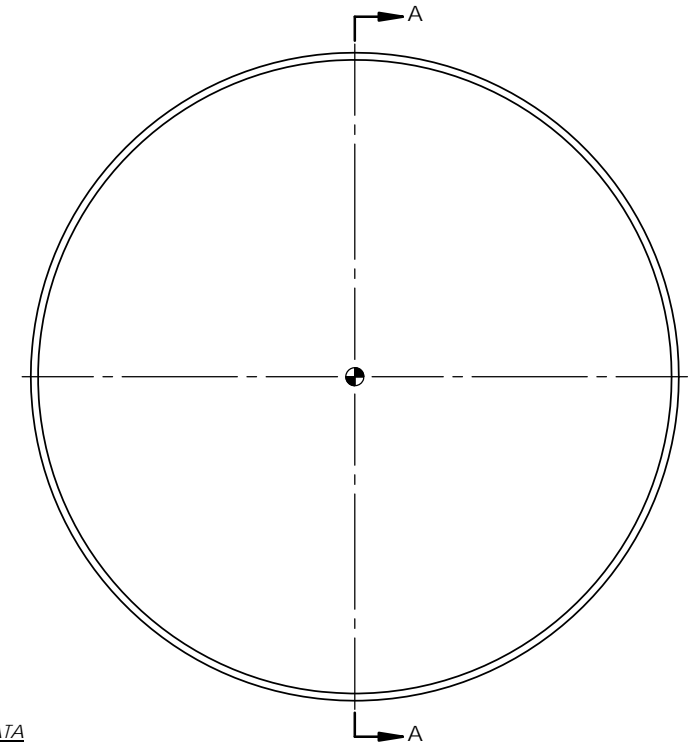
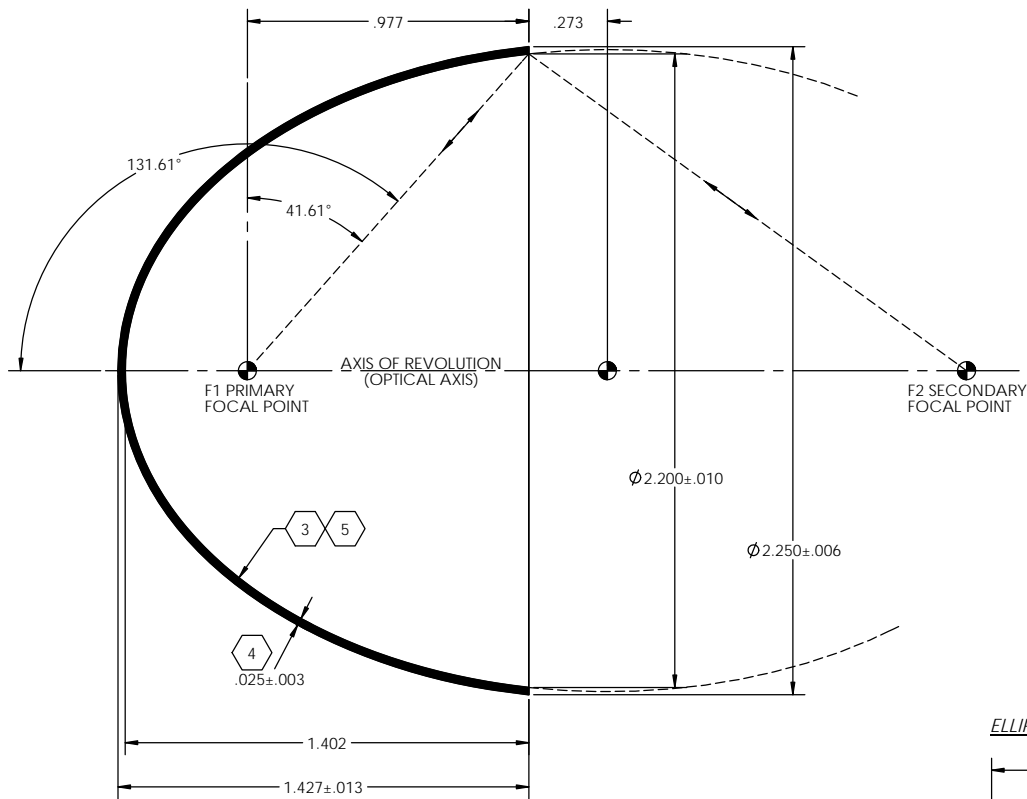

ELLIPTOID GEOMETRY DATA

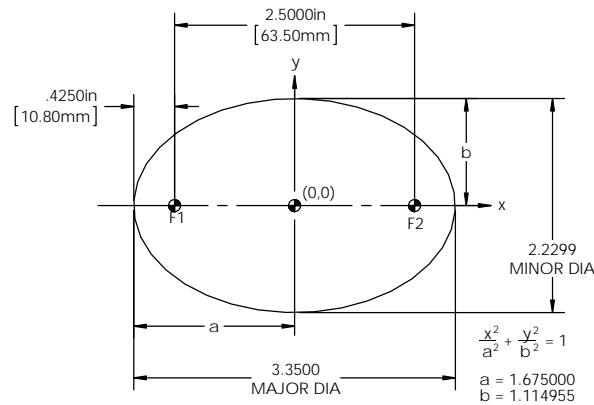

- REFLECTOR TO BE REPLICATED FROM SPECIFIED MASTER TOOL EXHIBITING REQUIRED ELLIPTICAL GEOMETRY AND SPECULAR SURFACE FINISH OF 80-50 SCRATCH-DIG PER MIL-0-13830A.
- NOMINAL THICKNESS MAY VARY ±.008 WITHIN .25 OF EDGES.
- FINAL REFLECTIVE SURFACE CONDITION WITH AVAILABLE REFLECTIVITY ENHANCEMENT COATINGS DEFINED AS FOLLOWS: (ADD DESIGNATED SUFFIX TO P/N)

- RH ELECTRO-DEPOSITED BRIGHT RHODIUM
- AO VACUUM DEPOSITED ALUMINUM WITH SiO₂ (QUARTZ)
- AF VACUUM DEPOSITED ALUMINUM WITH MgF₂ (MAGNESIUM FLUORIDE)
- DCC DICHROIC COLD COATING - SPECIFY WAVELENGTH REGION
- SP OTHER SPECIAL COATINGS AS SPECIFIED

TOTAL PLATED SURFACE AREA: 0.0598 S.F.

UNLESS OTHERWISE SPECIFIED DIMENSIONS ARE IN INCHES TOLERANCES ARE: FRACTIONS ± 1/16 DECIMALS .XX ± .003 XXX ± .005		CONTRACT NO. 00-E64	APPROVALS DRAWN JEH 04/18/12 CHECKED ENGR KMT 04/18/12 DESIGN ACTIVITY		DATE 04/18/12	42310 WINCHESTER RD. TEMECULA, CA 92590 WWW.OPTIFORMS.COM		
MATERIAL ELECTROFORMED NICKEL - LSSN TYPE 1		REFLECTOR, ELLIPTICAL NO VERTEX		SIZE C	CAGE CODE 0Y1Y4		DWG. NO. E64NV-0100	REV Ø
NEXT ASSY		USED ON		NOTE 3, 6		SCALE 3:1	CAD NO. E64	SHEET 1 OF 1
APPLICATION		-DO NOT SCALE DRAWING-						