

NOTES: UNLESS OTHERWISE SPECIFIED

- 1 ELECTROFORM REFLECTOR FROM MASTER TOOL WITH SPECULAR SURFACE QUALITY OF 80-50 SCRATCH-DIG PER MIL-PRF-13830B.
- 2 NOMINAL THICKNESS (T) MAY VARY ± 1/4 WITHIN .25 OF EDGES.
- 3 REFLECTIVE SURFACE COATING TO BE SEPARATELY SPECIFIED.

REVISIONS			
REV	DESCRIPTION	DATE	APPROVED
Ø	INITIAL DRAWING RELEASE BASED ON 2048-1.	09/05/08	MAS
A	INITIAL SOLIDWORKS DRAWING RELEASE	05/11/12	JEH
B	UPDATED TO CURRENT STANDARDS	10/23/17	JPH

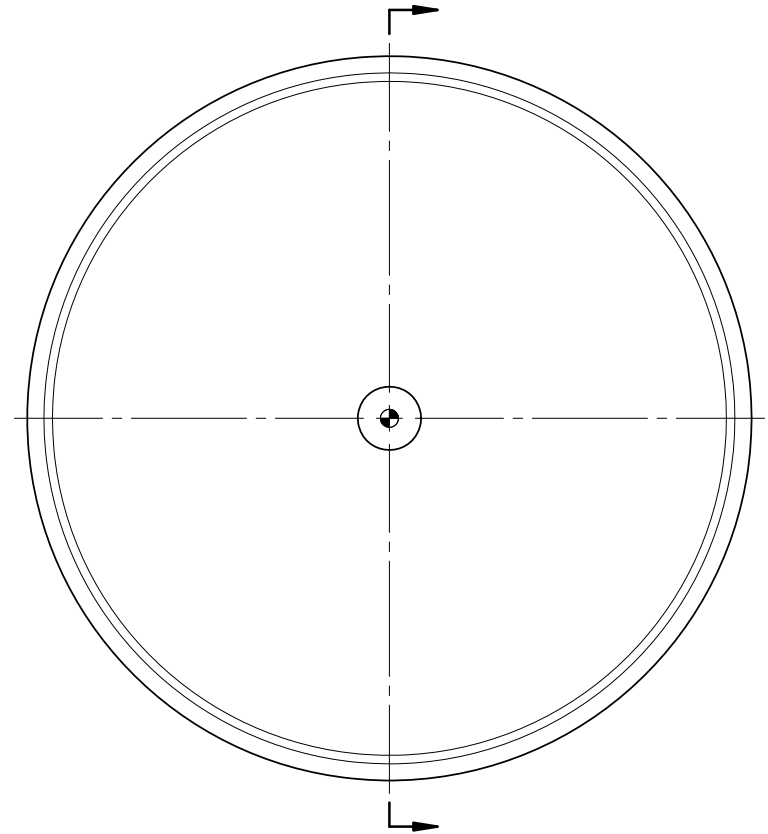
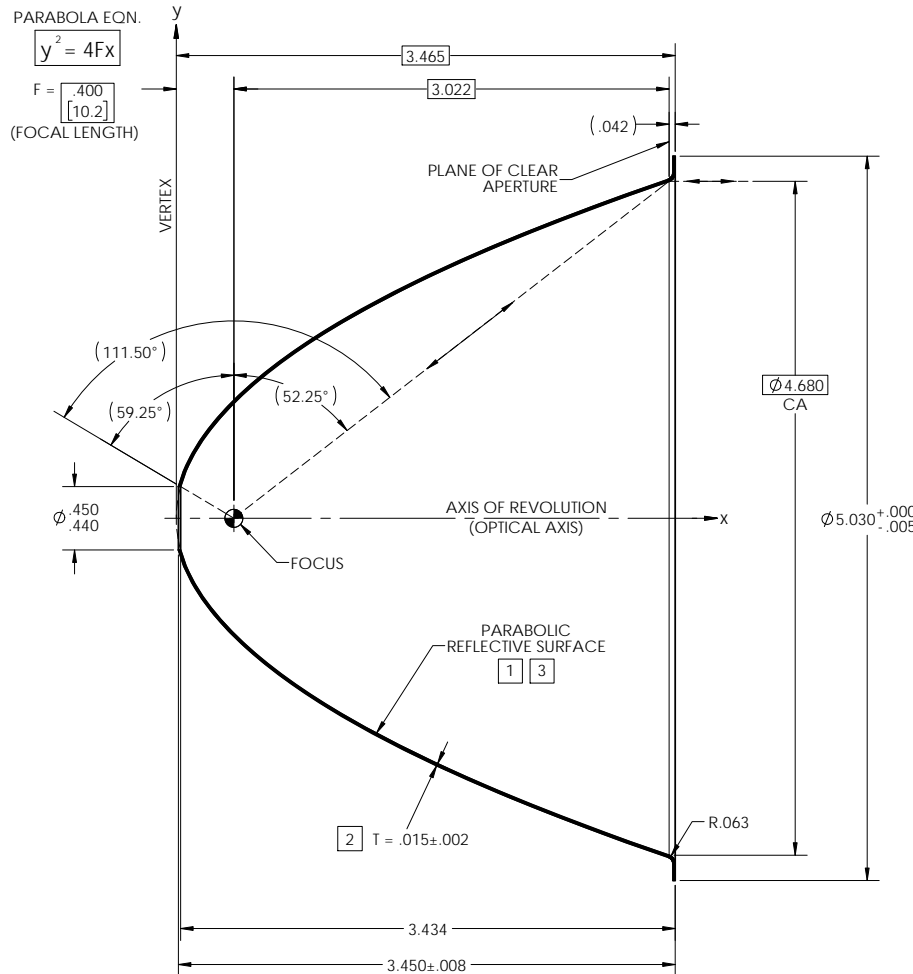

MASTER TOOL #102 (2048)  
EF SURFACE AREA = 0.2851 SQ. FT.

UNLESS OTHERWISE SPECIFIED DIMENSIONS ARE IN INCHES [mm] GD&T PER ASME Y14.5-2009 DO NOT SCALE DRAWING		CONTRACT NO. 08-P10F		42310 WINCHESTER RD. TEMECULA, CA 92590 WWW.OPTIFORMS.COM	
TOLERANCES		DRAWN MAS	DATE 09/05/08	SUBSTRATE, PARABOLIC 0.400" / 10mm FL	
FRACTIONS ± 1/16	DECIMALS XXX ± .02 .XXX ± .005	CHECKED	DATE		
ANGLES ± 1/2°		ENGR KMT	DATE 01/05/09	MATERIAL ELECTROFORMED NICKEL - LSSN TYPE 1	
SURFACE ROUGHNESS DEBURR SHARP EDGES & HOLES (RMS) .015 MAX. CHAMFER THREADS .01 PAST ROOT DIAMETER		FINISH SEE NOTE 3			
NEXT ASSY	USED ON	SCALE 3:2		WT 0.2 lbs.	CAD NO. P10F-0100
APPLICATION		THIRD ANGLE PROJECTION		SIZE C	CAGE CODE OY1Y4
				DWG. NO. P10F-0100	REV B
				SHEET 1 OF 1	