

NOTES: UNLESS OTHERWISE SPECIFIED

- 1 ELECTROFORM REFLECTOR FROM MASTER TOOL WITH SPECULAR SURFACE QUALITY OF 80-50 SCRATCH-DIG PER MIL-PRF-13830B.
- 2 NOMINAL THICKNESS (T) MAY VARY ± T/4 WITHIN .25 OF EDGES.
- 3 REFLECTIVE SURFACE COATING TO BE SEPARATELY SPECIFIED.

REVISIONS			
REV	DESCRIPTION	DATE	APPROVED
Ø	INITIAL DRAWING RELEASE	06/06/96	MJB
A	ADDED -14	03/18/97	KMT
B	ADDED -15,-16	08/25/97	KMT
C	REV DIM TOLERANCES	02/10/98	KMT
D	REV DIM TOLERANCES AND NOTES	07/01/98	GFW
E	ADDED -17	03/05/99	GFW
F	ADDED -18,-19	07/13/00	GFW
G	ADDED -20,-21	11/11/03	GFW
H	ADDED -22	11/02/04	GFW
J	ADDED -23	03/14/05	GFW
K	ADDED -24	02/05/07	KMT
L	ADDED -25,-26	08/08/07	SJM
M	ADDED -27	05/06/10	SJM
N	ADDED -28	02/14/12	RRS
P	UPDATED DRAWING FORMAT	07/26/17	JPH

DASH NO.	CA	V	OD	T	X	D	H	h	R°	F°	C°
P60	20.000	0.750	20.133	0.060	10.638	8.288	10.684	10.623	80.88	39.65	120.53
P60-0100	14.000	2.250	14.120	0.050	5.213	2.863	5.130	5.078	63.08	22.24	85.32
P60-0200	14.000	3.500	14.120	0.050	5.213	2.863	4.940	4.887	49.16	22.24	71.40
P60-0300	20.000	3.500	20.133	0.060	10.638	8.288	10.376	10.312	49.16	39.65	88.81
P60-0400	15.950	3.500	16.066	0.050	6.766	4.416	6.494	6.440	49.16	28.97	78.13
P60-0500	12.875	2.750	12.999	0.050	4.409	2.059	4.260	4.208	57.39	17.73	75.12
P60-0600	18.000	3.810	18.135	0.060	8.617	6.267	8.296	8.231	45.87	34.85	80.72
P60-0700	20.000	4.000	20.133	0.060	10.638	8.288	10.278	10.213	43.90	39.65	83.55
P60-0800	15.950	2.500	16.066	0.050	6.766	4.416	6.652	6.600	60.21	28.97	89.19
P60-0900	14.000	0.750	14.120	0.050	5.213	2.863	5.248	5.198	80.88	22.24	103.12
P60-1000	12.640	2.250	12.765	0.050	4.249	1.899	4.166	4.115	63.08	16.73	79.80
P60-1100	20.000	3.810	20.133	0.060	10.638	8.288	10.317	10.252	45.87	39.65	85.53
P60-1200	20.000	2.500	20.133	0.060	10.638	8.288	10.534	10.472	60.21	39.65	99.87
P60-1300	9.500	2.250	9.640	0.050	2.400	0.050	2.317	2.266	63.08	0.61	63.68
P60-1400	8.100	0.750	8.222	0.040	1.745	0.605	1.770	1.730	80.88	351.50	72.38
P60-1500	14.000	2.600	14.120	0.050	5.213	2.863	5.085	5.033	59.08	22.24	81.32
P60-1600	18.000	5.354	18.135	0.060	8.617	6.267	7.924	7.855	30.67	34.85	65.52
P60-1700	20.000	3.545	20.133	0.060	10.638	8.288	10.368	10.304	48.67	39.65	88.33
P60-1800	15.950	8.063	16.066	0.050	6.766	4.416	5.103	5.037	8.76	28.97	37.73
P60-1900	7.844	2.500	8.000	0.050	1.636	0.714	1.522	1.470	60.21	349.69	49.90
P60-2000	14.000	2.900	14.120	0.050	5.213	2.863	5.041	4.989	55.71	22.24	77.95
P60-2100	14.000	3.000	14.120	0.050	5.213	2.863	5.026	4.973	54.60	22.24	76.84
P60-2200	16.180	3.810	16.296	0.050	6.963	4.613	6.630	6.576	45.87	29.69	75.56
P60-2300	14.000	2.910	14.120	0.050	5.213	2.863	5.040	4.988	55.60	22.24	77.84
P60-2400	14.000	3.110	14.120	0.050	5.213	2.863	5.008	4.956	53.39	22.24	75.63
P60-2500	14.000	5.250	14.120	0.050	5.213	2.863	4.537	4.480	31.63	22.24	53.88
P60-2600	15.000	2.500	15.118	0.050	5.984	3.634	5.870	5.818	60.21	25.85	86.07
P60-2700	14.000	3.300	14.120	0.050	5.213	2.863	4.976	4.923	51.31	22.24	73.55
P60-2800	18.000	3.110	18.135	0.060	8.617	6.267	8.423	8.360	53.39	34.85	88.24

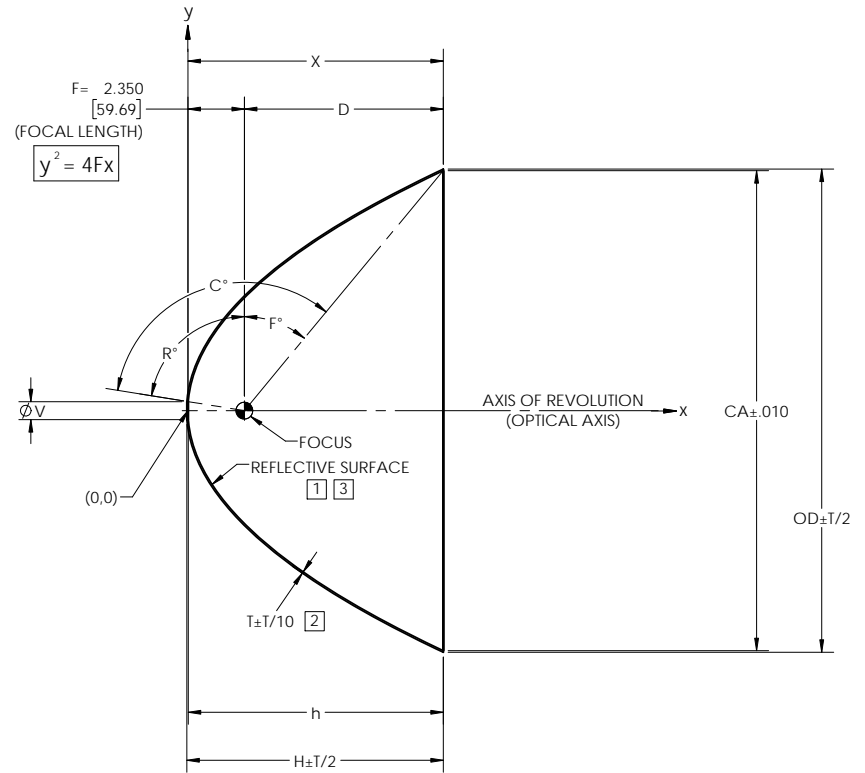

NOTE: THE "P60" DASH NO. IS THE THEORETICALLY LARGEST REFLECTOR THAT CAN BE FORMED ON EXISTING MASTER TOOLING.

UNLESS OTHERWISE SPECIFIED DIMENSIONS ARE IN INCHES (mm) GD&T PER ASME Y14.5-2009 DO NOT SCALE DRAWING		CONTRACT NO. 00-P60		optiforms® 42310 WINCHESTER RD. TEMECULA, CA 92590 WWW.OPTIFORMS.COM	
FRACTIONS ± 1/16 DECIMALS ± .02 ANGLES ± 1/2° XXX ± .005		DRAWN JIW DATE 07/26/17	REFLECTOR, PARABOLIC 2.350" / 60mm FL		
SURFACE ROUGHNESS √ DEBURR SHARP EDGES & HOLES RMB: 015 MAX. CHAMFER THREADS 01 PAST ROOT DIAMETER		CHECKED DATE	ELECTROFORMED NICKEL - LSSN TYPE 1		
THIRD ANGLE PROJECTION		ENGR RRS DATE 07/26/17	SCALE 1:4		
NEXT ASSY USED ON APPLICATION		MATERIAL FINISH		SIZE C	REV P
		SEE NOTES 1.3		CAGE CODE 0Y1Y4	DWG. NO. P60
				WT (REF)	CAD NO. P60
				SHEET 1 OF 1	